

THE LIDO II MODEL

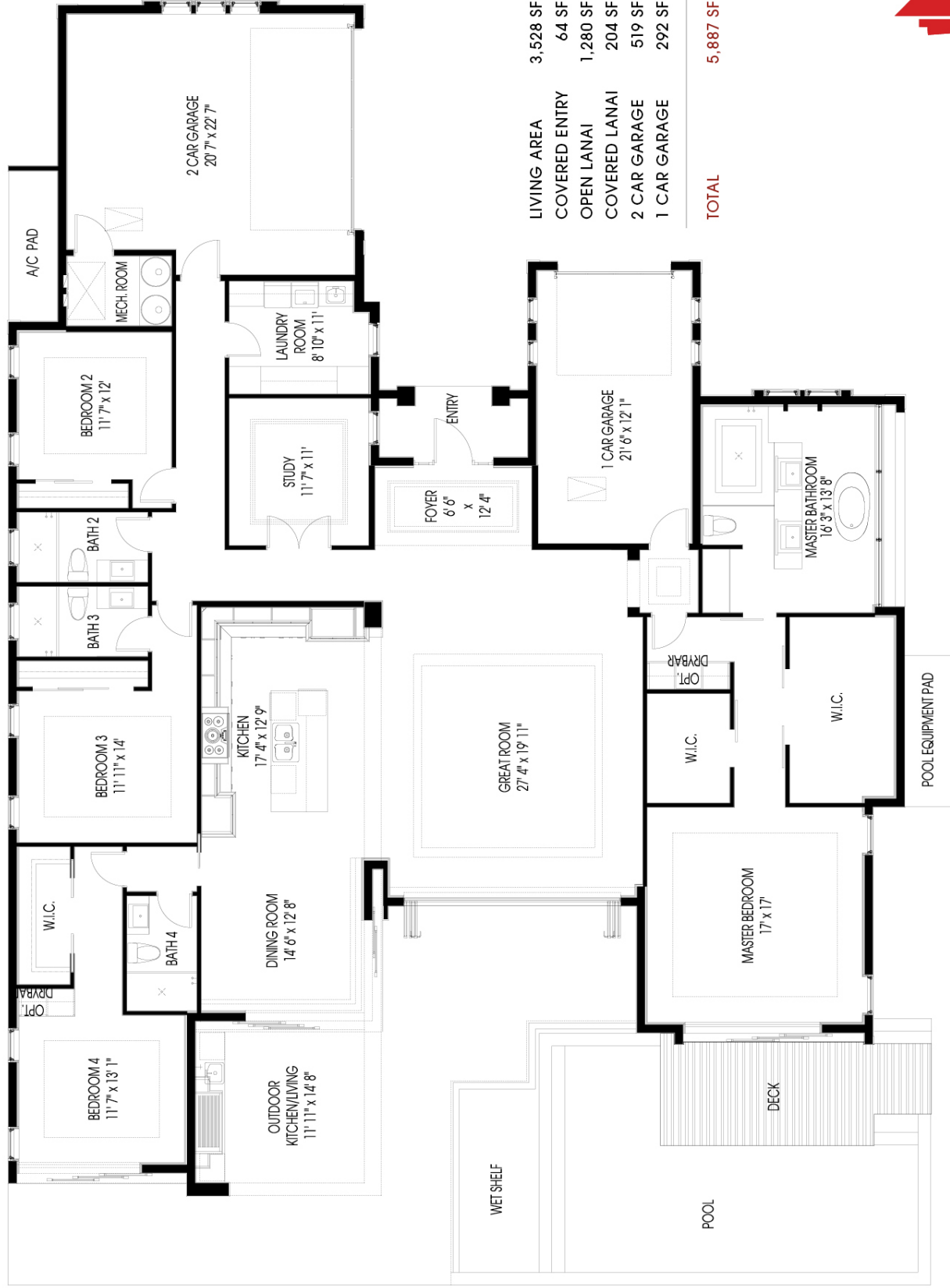

Broker participation welcomed. Prices, plans and specifications are subject to change without notice. ORAL REPRESENTATIONS CANNOT BE RELIED UPON AS CORRECTLY STATING REPRESENTATIONS OF THE DEVELOPER. FOR CORRECT REPRESENTATIONS, MAKE REFERENCE TO THIS BROCHURE AND TO THE DOCUMENTS REQUIRED BY SECTION 718.503, FLORIDA STATUTES, TO BE FURNISHED BY A DEVELOPER TO A BUYER OR LESSEE. NOT AN OFFERING WHERE PROHIBITED BY STATE LAW.

This rendering and floorplan is conceptual only and for the convenience of reference. It should not be relied upon as representation expressed or implied of the final detail, features, or dimensions of any residence. The Builder expressly reserves the right to make any modifications, revisions, and changes it deems desirable in its sole discretion or as may be required by law. All square footages are approximate. 01/2018

